

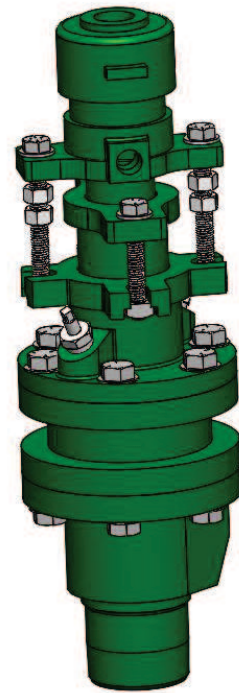

DUAL PACK STUFFING BOX



DUAL PACK STUFFING BOX W/ built in misalignment feature

THE MOST ADVANTAGE

- Built-in misalignment feature to overcome alignment issues between the polished rod or pumping unit
- Designed to fit onto most reciprocating units
- Competitive alternative to other stroker stuffing boxes
- Optional leak detection add-on
- Optional flapper valve add-on

TECHNICAL QUALIFICATIONS

- Grade 65-45-12 ductile iron
- Polished Rod Size: 1", 1 1/8", 1 1/4", 1 1/2", 1 3/4"
- Cone packing options:
 - Gold Flake
 - Special Lube
 - Soft Cone
 - Teflon Filled
 - High Temperature (to 425 F)
- Wellhead Connection Options:
 - API TUBING (EUE)
 - API LINE PIPE (LP)
- All MOST hardware can be customized to suit specific well requirements and conditions

www.mostoil.com